

#### Installation instructions KM129 seat into a Kubota L3901

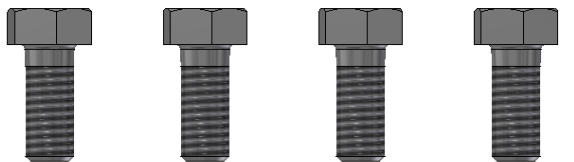

5/16"-18x3/4" HEX HEAD BOLTS



5/16" LOCK WASHERS

1. Remove old seat from hinge brackets.
2. Install new KM129 seat onto the existing brackets using 5/16"-18 x 3/4" bolts and 5/16" lock washers. Use the holes shown in the image below. NOTE: Use provided hardware to ensure the use of correct threads.
3. Tighten all hardware.

**NOTE:** The bolts are threading into clinch nuts, the bolts may not thread in by hand.

